

/ Perfect Welding / Solar Energy / Perfect Charging



FRONIUS GEN24 PLUS

UNIQUELY VERSATILE.



FRONIUS GEN24 PLUS

The versatile hybrid inverter with integrated backup power function.

The Fronius GEN24 Plus is the all-in-one solution for solar energy supply. Whether it is used in photovoltaics, a storage system, backup power, heating or e-mobility, the Fronius GEN24 Plus offers a unique range of solutions and is therefore playing a pioneering role in the home energy revolution.

www.fronius.com/gen24plus

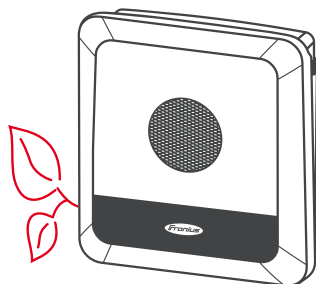

GEN24 Plus brings us another step closer to our vision of 24 hours of sun:

It's all about sustainability – throughout all phases of the product life cycle. The following facts confirm this:

- / Extension of the inverters service life thanks to active cooling
- / Comprehensive functions and open interfaces replace the need for additional equipment
- / > 90% recycled aluminium is used in the aluminium heat-sink





The all-in-one solution in detail

Tried-and-tested features are complemented by smart innovations

/ PV Point

Integrated basic backup power function

/ Energy Management

4 digital I/Os to increase self-consumption

/ Multi Flow Technology

Parallel energy flows, even when using grid backup

/ Dynamic Peak Manager

Maximum yields even in the case of partial shading

/ SuperFlex Design

Enables maximum flexibility in system design

/ Solar.web

System data and potential for optimisation potential visible at all times

/ Open interfaces

Easy integration of third party-systems

/ Active Cooling Technology

Long service life for the inverter

Awarded several times:



reddot award 2019 winner

TECHNICAL DATA	PRIMO GEN24 Plus	SYMO GEN24 Plus	
Single-phase / three-phase	single-phase 230 V	three-phase 230 / 400 V	
Power classes	3 / 3.6 / 4 / 4.6 / 5 / 6 kW	3 / 4 / 5 kW ¹	6 / 8 / 10 kW
MPP-Tracker	2	2	
Protection class	IP 66	IP 66	
Dimensions (height x width x depth)	474 x 530 x 165 mm	474 x 530 x 165 mm	529 x 595 x 180 mm
Weight	15.4 kg	15.6 kg	23.4 kg
DC input voltage range (U _{dc min} - U _{dc max})	65 V - 600 V	80 V - 1,000 V	
Compatible battery storage	BYD Battery-Box Premium HVS/HVM ²		

¹ The Full Backup option is not available with the Symo GEN24 Plus 3/4/5 kW.

² Compatibility depending on the inverter types.

Maximum independence thanks to custom backup power variants

Full Backup*

With the **Full Backup option**, the entire household, i.e. 1-phase as well as 3-phase devices, can be supplied with electricity in the event of a power outage.

- / Supplies the entire household (even three-phase loads)
- / Automatic switch to backup power in the event of grid failure
- / Efficient energy flows due to the Multi Flow Technology, even in backup power situations

PV Point

The **integrated basic backup power function**, the so-called **PV Point**, is a power socket supplied with electricity in the event of a power outage.

- / Automatic activation in case of a grid outage
- / Costly additional installation work is not necessary
- / Supplies households with one-phase loads of up to 3 kW

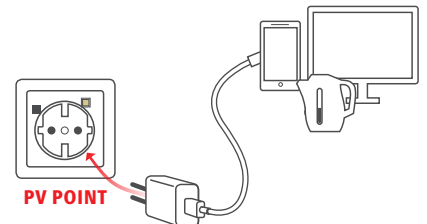

i *The Full Backup option is available for the Primo GEN24 Plus 3-6 kW and the Symo GEN24 Plus 6-10 kW.

Solar.start – the new commissioning app

With the new Solar.start app, you can configure your device in three steps via your smart device (smartphone, tablet):

- / Automatic connection to the devices
- / Simple and quick start-up and product registration
- / Linking to useful platforms (Solar.web/Solar.SOS, etc.)



The best service plan on the market

/ Extremely simple installation and servicing

Time and cost savings due to quick-release screws, push-in spring terminals and a sophisticated wall mounting system.

/ Upgrades possible at any time

Open interfaces make it easy to integrate third-party components such as home automation systems.

/ Smart monitoring with Solar.web

Monitor, analyse and compare different PV systems quickly and conveniently on your smartphone, tablet or laptop. Solar.web helps you deliver the best service to your customers.



GEN24 PLUS AT A GLANCE

Five reasons why the GEN24 Plus all-in-one solution is the right choice for your applications.



BASIC GRID BACKUP POWER FUNCTION ON BOARD

A free basic grid back-up (PV Point) is integrated in the GEN24 Plus as standard. The Full Backup option offers maximum independence.

EXTREMELY SIMPLE INSTALLATION, COMMISSIONING AND SERVICE

Quick-release screws, push-in spring terminals and a straightforward wall mounting system make it easy to both install and service the hybrid inverter. The inverter is easy to commission using an app on a smartphone or tablet.

MAXIMUM SELF-CONSUMPTION AND SELF-SUPPLY

Integrated energy management functions and open interfaces enable a maximum rate of self-consumption and selfsupply for e-mobility and hot water.

HYBRID INVERTER WITH MULTI FLOW TECHNOLOGY

The integrated Multi Flow Technology not only enables simultaneous energy flows in all directions, but also the AC, DC and AC & DC coupling of the battery storage system. This results in a high self-consumption rate and flexibility in the system.

COST SAVINGS

A number of integrated features (back-up power, system and energy analysis tool, integrated Dynamic Peak Manager, energy management function, SuperFlex Design, etc.) eliminate unnecessary additional costs.

i * The Full Backup option is available for the Primo GEN24 Plus 3-6 kW and the Symo GEN24 Plus 6-10 kW.

THREE BUSINESS UNITS, ONE GOAL: TO SET THE STANDARD THROUGH TECHNOLOGICAL ADVANCEMENT.

What began in 1945 as a one-man operation now sets technological standards in the fields of welding technology, photovoltaics and battery charging. Today, the company has around 5,440 employees worldwide and 1,264 patents for product development show the innovative spirit within the company. Sustainable development means for us to implement environmentally relevant and social aspects equally with economic factors. Our goal has remained constant throughout: to be the innovation leader.

PERFECT WELDING

Our mission is Perfect Welding; a task we have approached with passion and skill for decades in order that our customers can join materials with the perfect weld seam. With our outstanding technologies and services and together with our customer's applications, not only do we solve their specific welding technology problems, but we also make a substantial contribution to increasing their productivity.

SOLAR ENERGY

Our mission is to achieve 24 hours of sun. Day after day we are hard at work turning this vision of a future in which 100% of the world's energy needs are covered by renewable sources into a reality. We are therefore concentrating on solutions to intelligently, efficiently and economically generate, store, distribute and consume solar energy.

PERFECT CHARGING

As know-how leaders in the world of battery charging, we deliver exceptional solutions to create the maximum benefit for our customers. For the intralogistics sector, we are committed to energy flow optimisation for electric forklift trucks and are constantly striving for the next innovation. Our powerful charging systems for vehicle workshops guarantee safe and reliable processes.

Further information about all Fronius products and our global sales partners and representatives can be found at www.fronius.com

Fronius India Private Limited
Plot no BG-71/2/B,
Pimpri Industrial Area,
MIDC- Bhosari,
Pune- 411026, India
pv-sales-india@fronius.com
www.fronius.in

Fronius Australia Pty Ltd.
90-92 Lambeck Drive
Tullamarine VIC 3043
Australia
pv-sales-australia@fronius.com
www.fronius.com.au

Fronius UK Limited
Maidstone Road, Kingston
Milton Keynes, MK10 0BD
United Kingdom
pv-sales-uk@fronius.com
www.fronius.co.uk

Fronius International GmbH
Froniusplatz 1
4600 Wels
Austria
pv-sales@fronius.com
www.fronius.com



**TAKE BACK CONTROL OF YOUR
ENERGY CONSUMPTION
WITH FRONIUS SMART METERS**



WHAT IS A SMART METER?

A Fronius Smart Meter is a bidirectional meter that optimises self-consumption, records load curves, controls energy flows and limits the amount of energy sent back to the grid.

The Fronius Smart Meter range is compatible with all Fronius Gen24 Plus inverters as well as all other Fronius inverters with the Fronius Datamanager 2.0. You can also use them with the Fronius Ohmpilot.

FRONIUS SMART METER FOR ENERGY CONSUMPTION

The Fronius Smart Meter range allows system owners to record their energy consumption which is then graphically displayed in Fronius' free online portal, Solar.web. The intelligent system combines both the production and consumption data for the PV system enabling the system owner to better understand their energy usage, see where additional savings can be made and look at system additions such as battery storage.

Potential system errors can also be identified, ensuring any issues are fixed quickly thus limiting the downtime of the system and loss of energy production.



FRONIUS SMART METER FOR EXPORT LIMITATION

The Fronius Smart Meter range offers a simple and economical solution to export limitation and complies with current DNO requirements. The limitation is based on the inverter shifting its optimum operating point to adapt the output power to not exceed a predefined export value to the grid. This predefined value is set within a password protected area of the Fronius Datamanager web interface and is set in whole percentages from 0 - 100% or as a value in Watts.

HOW DOES IT WORK?

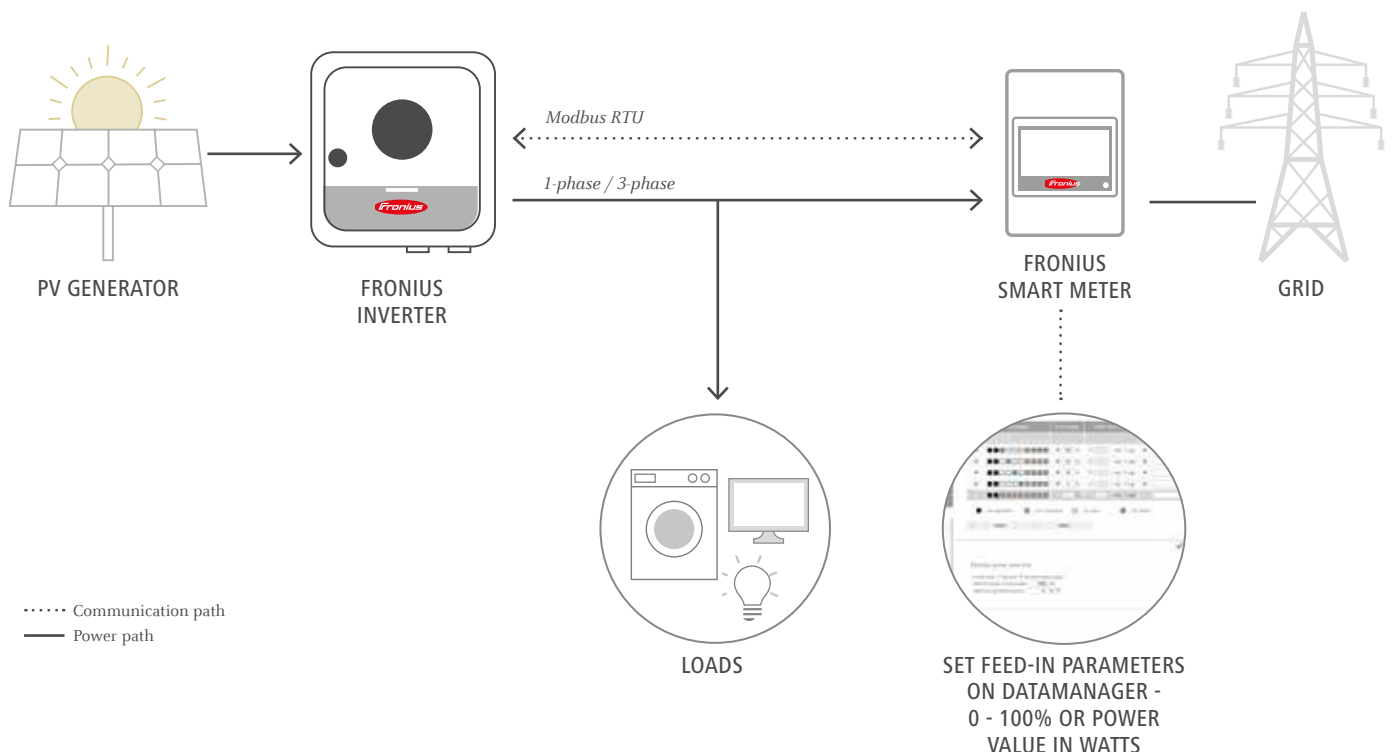

WHICH SMART METER DO I NEED?

To ensure you select the right smart meter for the job, use our helpful flow chart to lead you to the correct model.

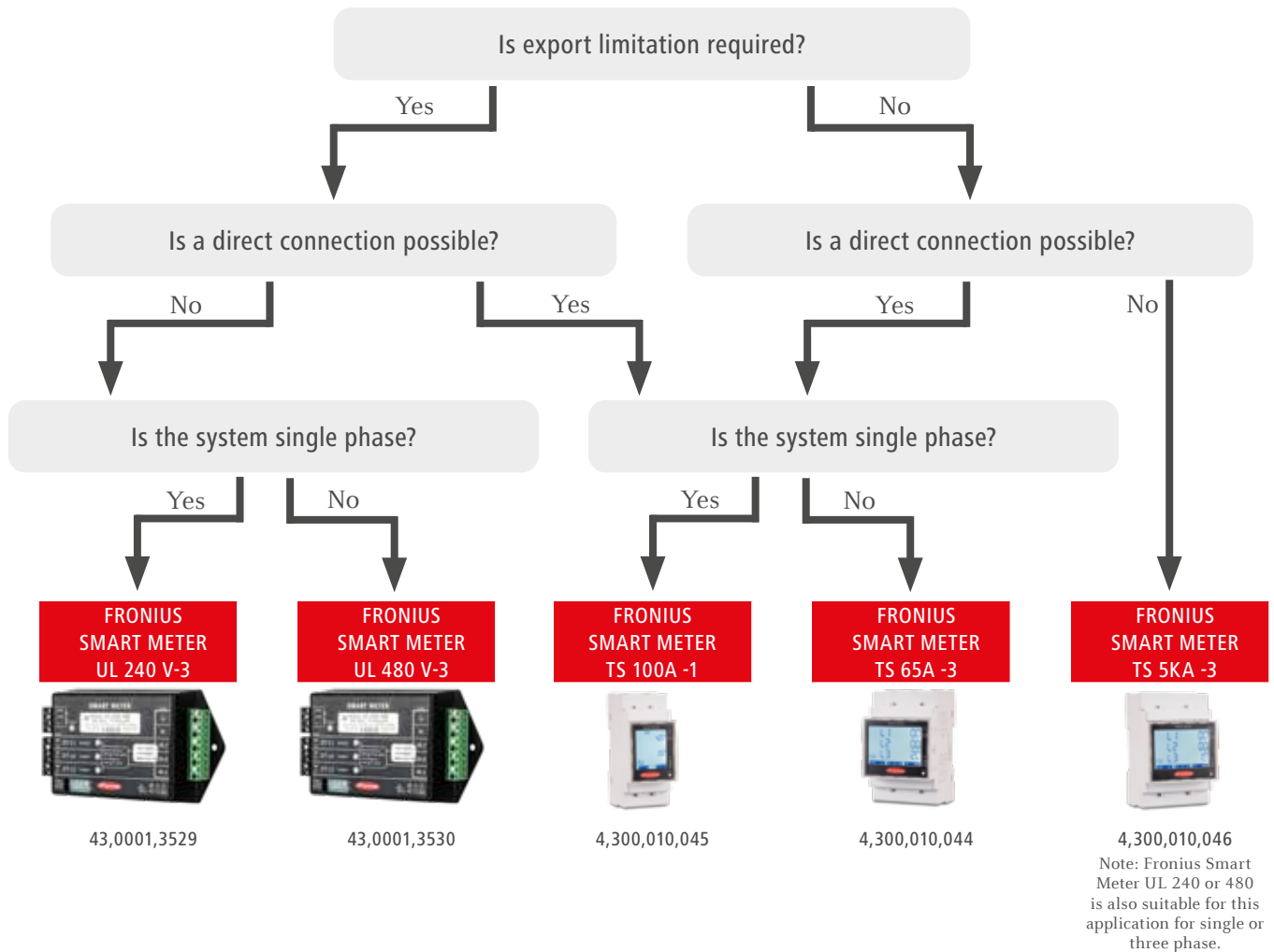

CT SELECTION

/ Voltage Type (0.333V)

For use with Fronius Smart Meter UL series
One CT for single phase Fronius Smart Meter UL 240
Three CT's for three phase Fronius Smart Meter UL 480

/ Current Type (5A)

For use with Fronius Smart Meter TS series
One CT for single phase installations
Three CT's for three phase installations

/ Direct Connection

Connect L and N directly through the Fronius Smart Meter
No CT's required
Requires site shut down for installation
Lowest cost option



FRONIUS SMART METER OVERVIEW



	FRONIUS SMART METER TS 100A -1	FRONIUS SMART METER TS 65A -3	FRONIUS SMART METER UL 240 V-3	FRONIUS SMART METER UL 480 V-3	FRONIUS SMART METER TS 5KA -3	FRONIUS SMART METER 50KA -3
Article No	43,0001,0045	43,0001,0044	43,0001,3529	43,0001,3530	43,0001,0046	43,0001,1478
Phases	Single Phase	Three Phase	Single Phase	Three Phase	Single, Two & Three Phase	Single, Two & Three Phase
CT's Required*	N/A	N/A	1 x 0.333V	3 x 0.333V	1/2/3 x 5A	1/2/3 x 5A
100A			42,0449,0097	42,0449,0097	42,0449,0046	42,0449,0046
150A			42,0449,0098	42,0449,0098		
250A			42,0449,0099	42,0449,0099	42,0449,0085	42,0449,0085
400A			42,0449,0100	42,0449,0100	42,0449,0073	42,0449,0073
Export Limitation	•	•	•	•		
Energy Management Relay	•	•	•	•	•	•
Gen24 Plus / Hybrid	•	•	•	•	•	•
SnapInverter	•	•	•	•	•	•
Ohmpilot	•	•	•	•	•	•
AC Connection	Direct Connection	Direct Connection	6A Single Phase MCB	6A Three Phase MCB	6A Three Phase MCB	6A Three Phase MCB
Datamanger Firmware	3.15.X	3.15.X		3.12.X	3.15.X	3.07.X
Dimensions (W x H x D)	36 x 92 x 60 mm	54 x 92 x 60 mm	143 x 85 x 38 mm	143 x 85 x 38 mm	54 x 92 x 60 mm	89 x 71 x 66 mm
Mounting	Din Rail	Din Rail	Threaded Fastener	Threaded Fastener	Din Rail	Din Rail

*Other CT sizes available upon request. • = compatible for

GAIN EXPERT KNOWLEDGE DIRECTLY FROM THE MANUFACTURER

The complexity and professionalism of our industry is constantly growing. To be successful it is becoming increasingly important to stand apart from the competition with your PV and energy system expertise. That is why we have a range of courses to guide you through the energy revolution.

Our trainers are all experienced employees with a technical background and know our products and the market inside and out. We regularly run our structured, hands-on training courses, but we can also offer bespoke training courses to suit your requirements - on-site or at our training facility in Milton Keynes.



CONTACT US

pv-training-uk@fronius.com

For more information, visit www.froniustraining.co.uk, call us on +44(0)1908 512 300 or email pv-training-uk@fronius.com.

You can also find all our upcoming webinars on our website to further boost your knowledge.

/ Perfect Welding / Solar Energy / Perfect Charging

THREE BUSINESS UNITS, ONE GOAL: TO SET THE STANDARD THROUGH TECHNOLOGICAL ADVANCEMENT.

What began in 1945 as a one-man operation now sets technological standards in the fields of welding technology, photovoltaics and battery charging. Today, the company has around 5,440 employees worldwide and 1,264 patents for product development show the innovative spirit within the company. Sustainable development means for us to implement environmentally relevant and social aspects equally with economic factors. Our goal has remained constant throughout: to be the innovation leader.

Further information about all Fronius products and our global sales partners and representatives can be found at www.fronius.com

Fronius UK Limited
Maidstone Road, Kingston
Milton Keynes, MK10 0BD
United Kingdom
pv-sales-uk@fronius.com
www.fronius.co.uk

Fronius International GmbH
Froniusplatz 1
4600 Wels
Austria
pv-sales@fronius.com
www.fronius.com



FRONIUS SYMO GEN24 PLUS

The hybrid allrounder with individual backup power



Integrated Data Communication



Dynamic Peak Manager



Multi Flow Technology



SuperFlex Design



Full backup¹



PV Point basic grid backup

The Fronius Symo GEN24 Plus, with power categories of between 3 and 10 kW, is the ideal hybrid inverter for private households. With many features as standard, the three-phase device covers all customer requirements.

The GEN24 Plus leaves nothing to be desired with numerous features such as energy management functions, WLAN connection as standard, Ethernet connectivity and easy integration of third-party components. Thanks to a selection of backup power options (PV Point, full backup¹) in particular, it ensures the highest degree of power supply reliability.

TECHNICAL DATA FRONIUS SYMO GEN24 PLUS (3.0, 4.0, 5.0)

INPUT DATA	SYMO GEN24 3.0 PLUS	SYMO GEN24 4.0 PLUS	SYMO GEN24 5.0 PLUS
Number of MPP trackers	2		
Max. input current ($I_{dc \max}$ MPPT1 / MPPT2)	12.5 A / 12.5 A		
Max. array short circuit current (MPPT1/MPPT2)	18.75 A / 18.75 A		
DC input voltage range ($U_{dc \min}$ - $U_{dc \max}$)	80 V - 1000 V		
Nominal input voltage ($U_{dc,r}$)	610 V		
Feed-in start voltage ($U_{dc \text{ start}}$)	80 V		
Usable MPP voltage range	80 V - 800 V		
Number of DC connections (MPPT1 / MPPT2)	2 / 1		
Max. PV generator output ($P_{dc \max}$)	4.5 kW _{peak}	6 kW _{peak}	7.5 kW _{peak}

OUTPUT DATA	SYMO GEN24 3.0 PLUS	SYMO GEN24 4.0 PLUS	SYMO GEN24 5.0 PLUS
AC nominal output ($P_{ac,r}$)	3000 W	4000 W	5000 W
Max. output power	3000 VA	4000 VA	5000 VA
Max. output current ($I_{ac \max}$)	8 A		
Grid connection (voltage range)	3-NPE 400 V / 230 V or 3-NPE 380 V / 220 V (+ 20 % / - 30%)		
Frequency (frequency range)	50 Hz / 60 Hz (45 Hz - 66 Hz)		
Total harmonic distortion	< 3.5 %		
Power factor ($\cos \phi_{ac,r}$)	0.7 - 1 ind. / cap.		

OUTPUT DATA PV POINT	SYMO GEN24 3.0 PLUS	SYMO GEN24 4.0 PLUS	SYMO GEN24 5.0 PLUS
Nom. output power PV Point	3000 VA		
Grid connection PV Point	1 - NPE 220 V / 230 V		
Switchover time	< 90 seconds		

¹ The Full Backup Option is available for the Symo GEN24 6.0 - 10.0 Plus. For the Full Backup, additional external components for grid separation are required. You can find more information on this in the operating instructions.

TECHNICAL DATA FRONIUS SYMO GEN24 PLUS (3.0, 4.0, 5.0)

BATTERY CONNECTION	SYMO GEN24 3.0 PLUS	SYMO GEN24 4.0 PLUS	SYMO GEN24 5.0 PLUS
Number of DC connections		1	
Max. input current ($I_{dc\ max}$)		12.5 A	
DC input voltage range ($U_{dc\ min} - U_{dc\ max}$)		160 V - 500 V	
Max. input / output power ²⁾	3,150 W	4,180 W	5,200 W
Max. AC charging power	3,000 W	4,000 W	5,000 W

GENERAL DATA	SYMO GEN24 3.0 PLUS	SYMO GEN24 4.0 PLUS	SYMO GEN24 5.0 PLUS
Dimensions (height x width x depth)		530 x 474 x 165 mm	
Weight (inverter / with packaging)		15,6 / 19,4	
Degree of protection		IP 66	
Protection class		1	
Nighttime power loss		< 10 W	
Overvoltage category (DC/AC) ³⁾		2 / 3	
Inverter design		Transformerless	
Cooling		Regulated air cooling	
Installation		Indoor and outdoor installation	
Ambient temperature range		- 25 - +60 °C	
Permitted humidity		0 - 100 %	
Noise Emission		< 36 dB (A)	
Max. altitude		3,000 m / 4,000 m (unrestricted / restricted voltage range)	
DC PV connection technology		3x DC+ and 3x DC- push-in spring terminals 2.5 - 10 mm ²	
DC battery connection technology		1x BATT+ and 1x BATT- push-in spring terminals 2.5 - 10 mm ²	
AC connection technology		5 pole AC push-in spring terminals 1.5 - 10 mm ² 3 pole backup power push-in spring terminals 1.5 mm ² - 10 mm ² 5x PE-screw terminals 2.5 - 16 mm ²	
Certificates and compliance with standards		IEC 62109, IEC 62116, IEC 61727, IEC 62909, VDE 0126, VDE AR-N4105, AS/NZS 4777.2, EN 50549, CEI 0-21, G 98, R25 ⁴⁾	
Back-up power functions		PV Point	
Compatible batteries		BYD Battery-Box Premium HVS/HVM ⁵⁾	

EFFICIENCY	SYMO GEN24 3.0 PLUS	SYMO GEN24 4.0 PLUS	SYMO GEN24 5.0 PLUS
Max. efficiency	98.1 %	98.2 %	98.2 %
Europ. efficiency (η_{EU})	96.7 %	97.2 %	97.5 %
MPP-tracking efficiency		> 99.9 %	

PROTECTIVE DEVICES	SYMO GEN24 3.0 PLUS	SYMO GEN24 4.0 PLUS	SYMO GEN24 5.0 PLUS
DC insulation measurement		Yes	
DC insulation measurement		Operating point shift. Power limitation	
DC disconnect		Yes	
Reverse polarity protection		Yes	

INTERFACES	SYMO GEN24 3.0 PLUS	SYMO GEN24 4.0 PLUS	SYMO GEN24 5.0 PLUS
WLAN / 2x Ethernet LAN		Fronius Solar.web, Modbus TCP SunSpec, Fronius Solar API (JSON)	
6x digital in/out + 6x digital in		Interface to ripple control receiver, energy management	
USB 2.0 (A-socket)		1 A supply	
Emergency stop (WSD)		Yes	
Datalogger and webserver		Included	
2x RS485		Modbus RTU SunSpec (third-party supplier) / Fronius Smart Meter, battery, Fronius Ohmpilot	

²⁾ Depending on the connected battery

³⁾ According to IEC 62109-1. Optional retrofit surge protection device DC SPD type 1+2 for 2 MPP trackers available under the following article number: 4,240,313,CK

⁴⁾ For the current certificates, please see www.fronius.com

⁵⁾ Except HVS 12.8 and HVM 8.3

For further information on the availability of this inverter in your country please see www.fronius.com.

TECHNICAL DATA FRONIUS SYMO GEN24 PLUS (6.0, 8.0, 10.0)

INPUT DATA	SYMO GEN24 6.0 PLUS	SYMO GEN24 8.0 PLUS	SYMO GEN24 10.0 PLUS
Number of MPP trackers	2		
Max. input current ($I_{dc \max}$ MPPT1 / MPPT2)	25 A / 12,5 A		
Max. array short circuit current (MPPT1/MPPT2)	37.5 A / 18.75 A		
DC input voltage range ($U_{dc \min}$ - $U_{dc \max}$)	80 V - 1,000 V		
Nominal input voltage ($U_{dc,r}$)	610 V		
Feed-in start voltage ($U_{dc \text{ start}}$)	80 V		
Usable MPP voltage range	80 V - 800 V		
Number of DC connections (MPPT1 / MPPT2)	2 / 1		
Max. PV generator output ($P_{dc \max}$)	9 kW _{peak}	12 kW _{peak}	15 kW _{peak}

OUTPUT DATA	SYMO GEN24 6.0 PLUS	SYMO GEN24 8.0 PLUS	SYMO GEN24 10.0 PLUS
AC nominal output ($P_{ac,r}$)	6,000 W	8,000 W	10,000 W
Max. output power	6,000 VA	8,000 VA	10,000 VA
Max. output current ($I_{ac \max}$)	16.4 A		
Grid connection (voltage range)	3~NPE 400 V / 230 V or 3~NPE 380 V / 220 V (+ 20 % / - 30%)		
Frequency (frequency range)	50 Hz / 60 Hz (45 Hz - 66 Hz)		
Total harmonic distortion	< 3.5 %		
Power factor ($\cos \phi_{ac,r}$)	0.7 - 1 ind. / cap.		
Backup power	3~NPE 400 V / 230 V		

OUTPUT DATA PV POINT / FULL BACKUP ¹⁾	SYMO GEN24 6.0 PLUS	SYMO GEN24 8.0 PLUS	SYMO GEN24 10.0 PLUS
Nom. output power PV Point / full backup	3,000 VA / 6,000 VA	3,000 VA / 8,000 VA	3,000 VA / 10,000 VA
Nominal power per phase full backup	3.68 kVA		
Grid connection (voltage range) PV Point	1 ~ NPE 220 V / 230 V		
Grid connection (voltage range) full backup	3~NPE 400V/230V or 3~NPE 380V/220V		
Switchover time	< 90 seconds		

¹⁾ The Full Backup Option is available for the Symo GEN24 6.0 - 10.0 Plus. For the Full Backup, additional external components for grid separation are required. You can find more information on this in the operating instructions.

TECHNICAL DATA FRONIUS SYMO GEN24 PLUS (6.0, 8.0, 10.0)

BATTERY CONNECTION	SYMO GEN24 6.0 PLUS	SYMO GEN24 8.0 PLUS	SYMO GEN24 10.0 PLUS
Number of DC connections		1	
Max. input current ($I_{dc\ max}$)		22 A	
DC input voltage range ($U_{dc\ min} - U_{dc\ max}$)		160 V - 500 V	
Max. input / output power ²⁾	6,220 W	8,260 W	10,300 W
Max. AC charging power	6,000 W	8,000 W	10,000 W

GENERAL DATA	SYMO GEN24 6.0 PLUS	SYMO GEN24 8.0 PLUS	SYMO GEN24 10.0 PLUS
Dimensions (height x width x depth)		595 x 529 x 180 mm	
Weight (inverter / with packaging)		23,4 / 28,5 kg	
Degree of protection		IP 66	
Protection class		1	
Nighttime power loss		< 10 W	
Overvoltage category (DC/AC) ³⁾		2 / 3	
Inverter design		Transformerless	
Cooling		Regulated air cooling	
Installation		Indoor and outdoor installation	
Ambient temperature range		-25 - +60 °C	
Permitted humidity		0 - 100 %	
Noise Emission		< 47 dB (A)	
Max. altitude		3,000 m / 4,000 m (unrestricted / restricted voltage range)	
DC PV connection technology		3x DC+ and 3x DC- push-in spring terminals 2.5 - 10 mm ²	
DC battery connection technology		1x BATT+ and 1x BATT- push-in spring terminals 2.5 - 10 mm ²	
AC connection technology		5 pole AC push-in spring terminals 1.5 - 10 mm ² 3 pole backup power push-in spring terminals 1.5mm ² - 10mm ² 5x PE-screw terminals 2.5 - 16 mm ²	
Certificates and compliance with standards		IEC 62109, IEC 62116, IEC 61727, IEC 62909, VDE 0126, VDE AR-N4105, AS/NZS 4777.2, EN 50549, CEI 0-21, G 98, R25 ⁴⁾	
Back-up power functions		PV Point or Full Backup	
Compatible batteries		BYD Battery-Box Premium HVS/HVM ⁵⁾	

EFFICIENCY	SYMO GEN24 6.0 PLUS	SYMO GEN24 8.0 PLUS	SYMO GEN24 10.0 PLUS
Max. efficiency		98.2 %	
Europ. efficiency (η_{EU})	97.7 %	97.8 %	97.9 %
MPP-tracking efficiency		> 99.9 %	

PROTECTIVE DEVICES	SYMO GEN24 6.0 PLUS	SYMO GEN24 8.0 PLUS	SYMO GEN24 10.0 PLUS
DC insulation measurement		Yes	
Overload behaviour		Operating point shift. Power limitation	
DC disconnect		Yes	
Reverse polarity protection		Yes	

INTERFACES	SYMO GEN24 6.0 PLUS	SYMO GEN24 8.0 PLUS	SYMO GEN24 10.0 PLUS
WLAN / 2x Ethernet LAN		Fronius Solar.web, Modbus TCP SunSpec, Fronius Solar API (JSON)	
6x digital in/out + 6x digital in		Interface to ripple control receiver, energy management	
USB 2.0 (A-socket)		1 A supply	
Emergency stop (WSD)		Yes	
Datalogger and webserver		Included	
2x RS485		Modbus RTU SunSpec (third-party supplier) / Fronius Smart Meter, battery, Fronius Ohmpilot	

²⁾ Depending on the connected battery

³⁾ According to IEC 62109-1. Optional retrofit surge protection device DC SPD type 1+2 for 2 MPP trackers available under the following article number: 4,240,313,CK

⁴⁾ For the current certificates, please see www.fronius.com

⁵⁾ Except HVS 12.8 and HVM 8.3

For further information on the availability of this inverter in your country please see www.fronius.com.

FRONIUS SYMO GEN24 PLUS 6.0 EFFICIENCY CURVE

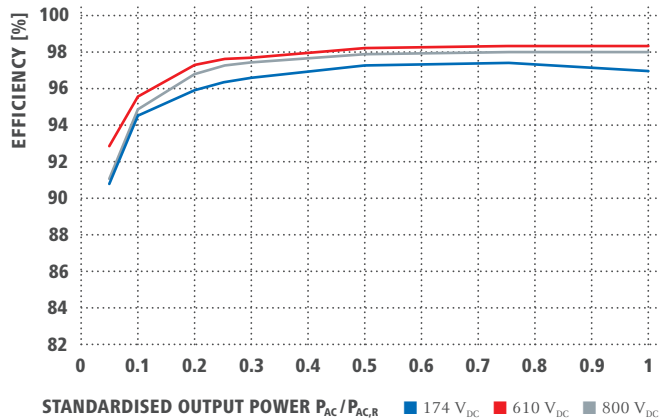

FRONIUS SYMO GEN24 PLUS 6.0 TEMPERATURE DERATING

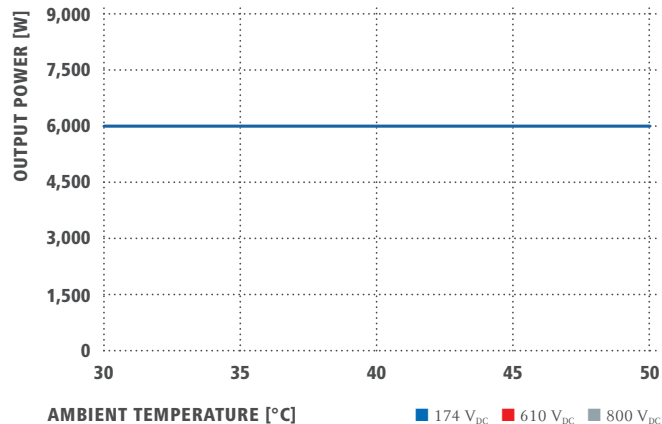

FRONIUS SYMO GEN24 PLUS 8.0 EFFICIENCY CURVE

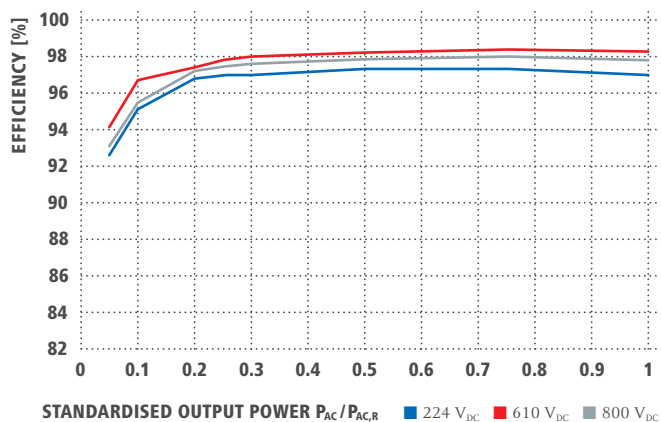

FRONIUS SYMO GEN24 PLUS 8.0 TEMPERATURE DERATING

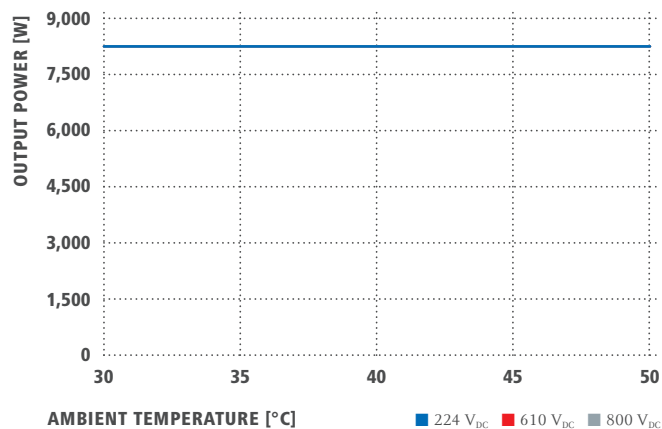

FRONIUS SYMO GEN24 PLUS 10.0 EFFICIENCY CURVE

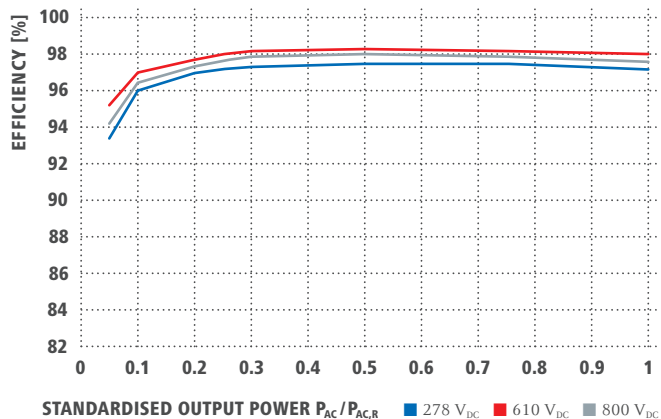

FRONIUS SYMO GEN24 PLUS 10.0 TEMPERATURE DERATING

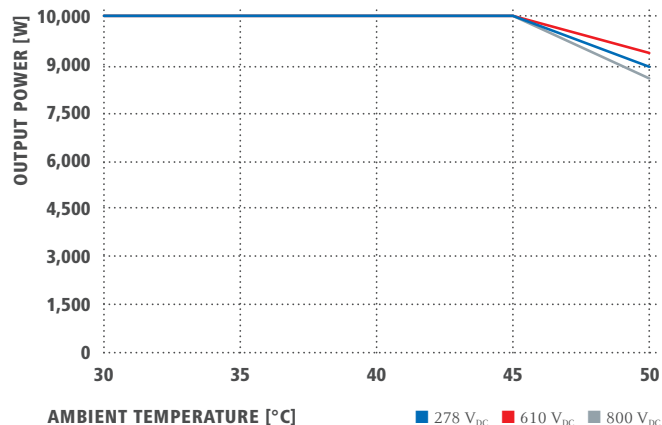

THREE BUSINESS UNITS, ONE GOAL: TO SET THE STANDARD THROUGH TECHNOLOGICAL ADVANCEMENT.

What began in 1945 as a one-man operation now sets technological standards in the fields of welding technology, photovoltaics and battery charging. Today, the company has around 5,440 employees worldwide and 1,264 patents for product development show the innovative spirit within the company. Sustainable development means for us to implement environmentally relevant and social aspects equally with economic factors. Our goal has remained constant throughout: to be the innovation leader.

PERFECT WELDING

Our mission is Perfect Welding; a task we have approached with passion and skill for decades in order that our customers can join materials with the perfect weld seam. With our outstanding technologies and services and together with our customer's applications, not only do we solve their specific welding technology problems, but we also make a substantial contribution to increasing their productivity.

SOLAR ENERGY

Our mission is to achieve 24 hours of sun. Day after day we are hard at work turning this vision of a future in which 100% of the world's energy needs are covered by renewable sources into a reality. We are therefore concentrating on solutions to intelligently, efficiently and economically generate, store, distribute and consume solar energy.

PERFECT CHARGING

As know-how leaders in the world of battery charging, we deliver exceptional solutions to create the maximum benefit for our customers. For the intralogistics sector, we are committed to energy flow optimisation for electric forklift trucks and are constantly striving for the next innovation. Our powerful charging systems for vehicle workshops guarantee safe and reliable processes.

Further information about all Fronius products and our global sales partners and representatives can be found at www.fronius.com

Fronius India Private Limited
Plot no BG-71/2/B,
Pimpri Industrial Area,
MIDC- Bhosari,
Pune- 411026, India
pv-sales-india@fronius.com
www.fronius.in

Fronius Australia Pty Ltd.
90-92 Lambeck Drive
Tullamarine VIC 3043
Australia
pv-sales-australia@fronius.com
www.fronius.com.au

Fronius UK Limited
Maidstone Road, Kingston
Milton Keynes, MK10 0BD
United Kingdom
pv-sales-uk@fronius.com
www.fronius.co.uk

Fronius International GmbH
Froniusplatz 1
4600 Wels
Austria
pv-sales@fronius.com
www.fronius.com